

# \$609,999 - 112 Legacy Reach Court Se, Calgary

MLS® #A2232222

**\$609,999**

3 Bedroom, 3.00 Bathroom, 1,747 sqft  
Residential on 0.06 Acres

Legacy, Calgary, Alberta

OVER 1700 SQFT LIVING SPACE | LONG KITCHEN CENTRAL ISLAND | BONUS ROOM| SEPARATE ENTRANCE. This Beautiful Brand New Home built by Shane Homes Located on a Quiet Street in the Heart of Legacy with convenient access to restaurants, shopping, amenities, and schools. Upon Entry, the great room is designed with huge east-facing windows to have natural light sweeping throughout the day. The open-style living room invites you to the elegant kitchen filled with trendy selections, a pantry, Quartz countertops and stainless steel appliances and beautiful luxury vinyl plank throughout. Upstairs, youâ€™ll find two equally sized secondary bedrooms, bathroom and laundry space, along with a 3 - piece master suite including a walk-in closet. Thereâ€™s also a spacious bonus room at the centre of the house thatâ€™s roomy enough to host a large sectional sofa and entertainment unit, ideal for family movie nights. This exquisite home comes with a myriad of upgrades including 9 ft. ceiling heights on the main, Upgraded sleek cabinetry, LED pot lights, knock-down ceiling and modern lighting fixtures!

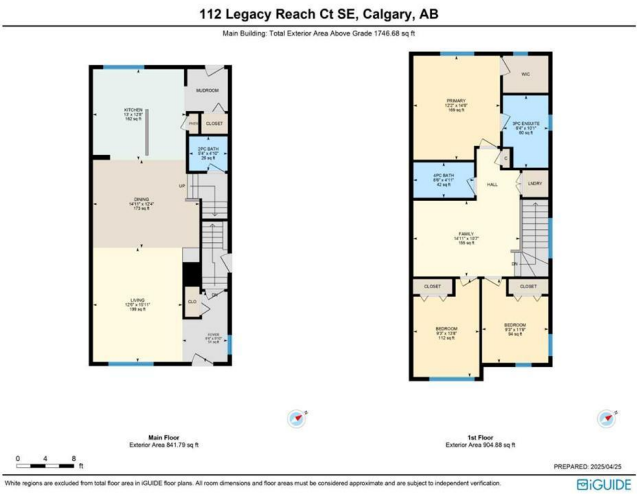

Built in 2024

## Essential Information

MLS® #                   A2232222  
Price                    \$609,999

Bedrooms	3
Bathrooms	3.00
Full Baths	2
Half Baths	1
Square Footage	1,747
Acres	0.06
Year Built	2024
Type	Residential
Sub-Type	Semi Detached
Style	2 Storey, Side by Side
Status	Active

### Community Information

Address	112 Legacy Reach Court Se
Subdivision	Legacy
City	Calgary
County	Calgary
Province	Alberta
Postal Code	T2X5V2

### Amenities

Parking Spaces	2
Parking	Off Street, Parking Pad

### Interior

Interior Features	Bathroom Rough-in, High Ceilings, Kitchen Island, No Animal Home, No Smoking Home, Open Floorplan, Quartz Counters
Appliances	Dishwasher, Electric Range, Range Hood, Refrigerator, Washer/Dryer
Heating	Forced Air
Cooling	None
Has Basement	Yes
Basement	Exterior Entry, Full, Unfinished

### Exterior

Exterior Features	Playground
Lot Description	Back Lane
Roof	Asphalt Shingle
Construction	Vinyl Siding, Wood Frame
Foundation	Poured Concrete

**Additional Information**

Date Listed	June 17th, 2025
Days on Market	60
Zoning	R-G

**Listing Details**

Listing Office	Executive Real Estate Services
----------------	--------------------------------

Data is supplied by Pillar 9â„¸ MLSÂ® System. Pillar 9â„¸ is the owner of the copyright in its MLSÂ® System. Data is deemed reliable but is not guaranteed accurate by Pillar 9â„¸. The trademarks MLSÂ®, Multiple Listing ServiceÂ® and the associated logos are owned by The Canadian Real Estate Association (CREA) and identify the quality of services provided by real estate professionals who are members of CREA. Used under license.